

PARTS

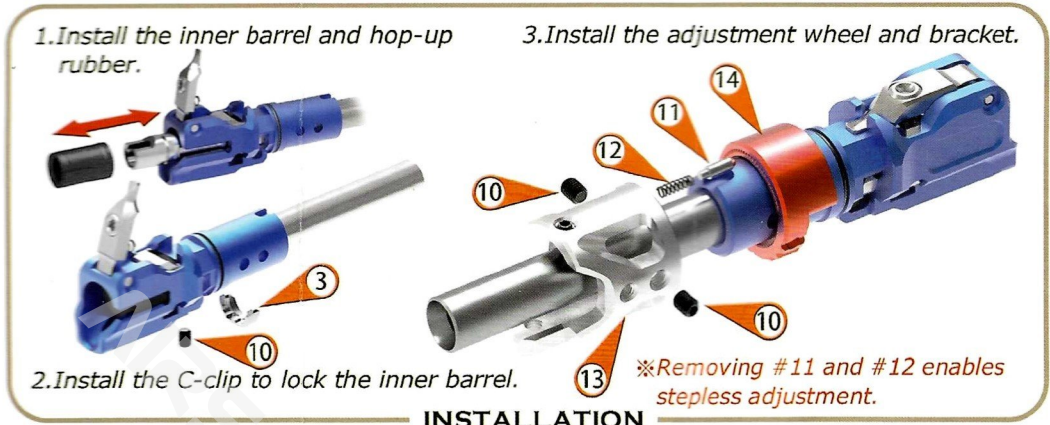

INSTALLATION

※Removing #11 and #12 enables stepless adjustment.

[ADJUSTMENT WHEEL MODE]
For AAC original, TTI Scorpion series/Mini Mamba.

[ADJUSTMENT SCREW MODE]
For AAC original (Drilling required) TTI Scorpion series/Mini Mamba

[TTI PCC ADJUSTMENT MODE]
For TTI PCC KIT

⚠ Adjust the #7 compression rod to its lowest position first, then remove the #5 screw and place it into the #6 cylinder.

ADJUSTMENT MODE

Assembly part number : #1, #4, #7, #10, #13, #14, #15

Drill bit sizes : $\varnothing 2.3\text{mm} \sim \varnothing 2.6\text{mm}$

DRILL HOLE

TTI INFINITY AAP-01/01C TDC HOP-UP CHAMBER